

NITRILE BUCKET WASHER / SEAL

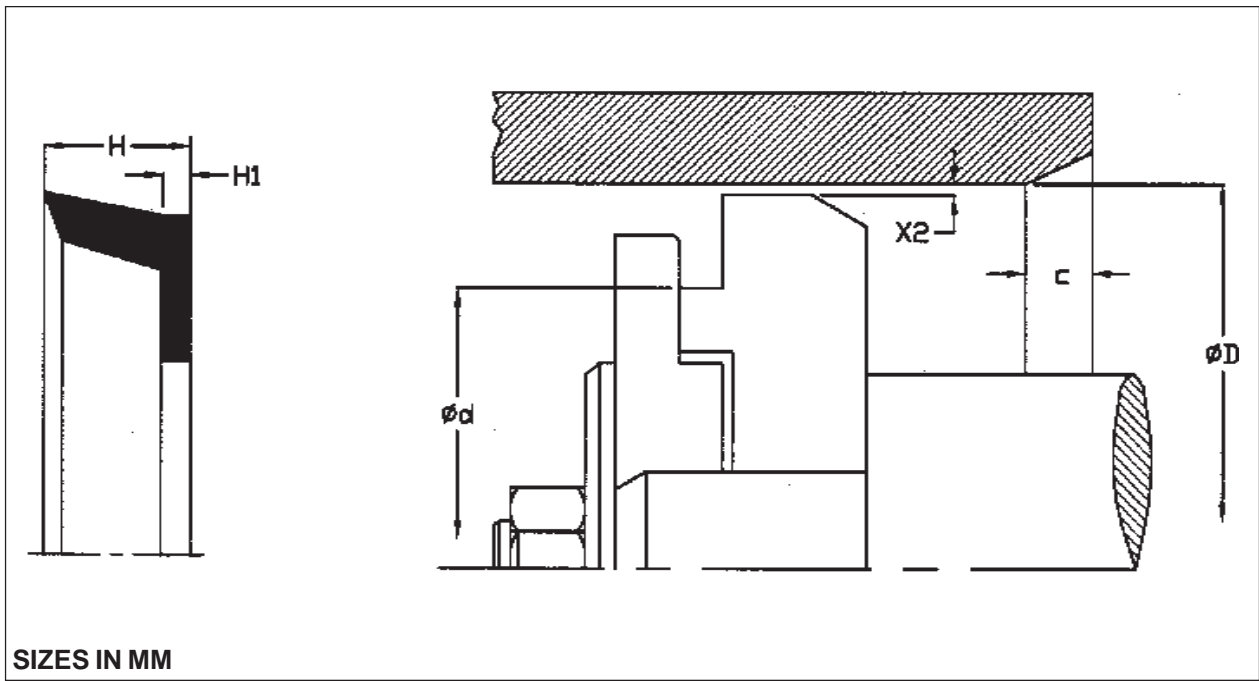

SIZES IN MM

I.D. x O.D. x Th.	PRICE PER NO.	I.D. x O.D. x Th.	PRICE PER NO.	I.D. x O.D. x Th.	PRICE PER NO.	I.D. x O.D. x Th.	PRICE PER NO.
0 x 14 x 9	27.00	14 x 60 x 19	113.10	29 x 50 x 15	56.10	105 x 152.4 x 20	321.60
0 x 15 x 7.3	27.00	15 x 25.5 x 16	31.20	30 x 62 x 12	79.80	110 x 150 x 15	226.80
0 x 25 x 8	29.70	15 x 80 x 25	223.20	31 x 52 x 15	58.50	115 x 150 x 16	220.50
0 x 28.5 x 7.3	30.30	15.5 x 53.2 x 10.5	59.40	31.75 x 151.9 x 20	552.00	120 x 148 x 15.5	171.30
0 x 28.5 x 10	32.10	16 x 32 x 15	45.30	31.8 x 66.5 x 12	84.60	120.5 x 150 x 16	180.60
0 x 32 x 8.5	42.90	16 x 76 x 16.5	148.50	35 x 55.5 x 10.8	53.40	123 x 158 x 15	219.90
0 x 35 x 10	45.90	17 x 25.7 x 9	28.20	36.6 x 53.5 x 5.5	34.80	127 x 203.2 x 13.63	474.00
0 x 37.8 x 8.5	45.90	17 x 51 x 10	56.10	38 x 57 x 12	54.90	133 x 254.1 x 28	1,449.90
0 x 100 x 12	169.80	17.46 x 34 x 11	43.50	38 x 83.5 x 19	159.90	133.35 x 203.2 x 20.95	596.10
0 x 100 x 16	227.70	17.5 x 28 x 7	28.20	39 x 74.3 x 12.6	101.40	139 x 165 x 13	160.20
4 x 10 x 3	25.80	18 x 35 x 12	44.70	39.68 x 76 x 12.7	103.80	145 x 216 x 25	809.40
4 x 12.8 x 8	26.40	18 x 37 x 15	48.60	40 x 50.5 x 5.5	32.10	152 x 255 x 27	1,302.60
4 x 20 x 12	29.40	18 x 37.5 x 11.5	46.20	40 x 60 x 10	53.40	152.5 x 220 x 28	861.00
4.8 x 10 x 4	25.80	18 x 51 x 9.5	54.60	40 x 63.5 x 10	57.00	153 x 190 x 14	267.60
4.8 x 16 x 11.5	27.60	19 x 59.7 x 9.5	61.80	40 x 75 x 15	109.50	158 x 198 x 11.5	233.10
5 x 16.35 x 10	27.60	19 x 62 x 16	105.60	40 x 115 x 15	264.90	166 x 200 x 16	285.00
6 x 13.2 x 8	26.40	19 x 70 x 11.5	102.90	42 x 254 x 28	1,812.60	170 x 203 x 17	295.50
6.35 x 25.4 x 5.15	28.20	20 x 40 x 7	33.60	44 x 65 x 8	51.90	170 x 242 x 15	557.40
6.5 x 15 x 6.5	26.40	20 x 41 x 10.5	46.80	45 x 58 x 8	45.90	171 x 207 x 18	324.60
6.5 x 15 x 9.5	27.00	20 x 50.8 x 18	83.10	48 x 80 x 30	174.30	180 x 240 x 17	543.60
6.5 x 16 x 9.5	27.30	20 x 53 x 19	97.50	49 x 85 x 15	132.90	180 x 280 x 20	1,129.80
6.5 x 17 x 9.5	27.60	20 x 100 x 20	276.90	50 x 88 x 11	107.40	184 x 218 x 19	360.00
7.7 x 36.2 x 15	51.30	22 x 54 x 10	57.00	50.8 x 76.2 x 12.7	84.30	185 x 217 x 19	324.30
8.3 x 50.3 x 14	79.20	22 x 54 x 10.5	57.90	51.5 x 152 x 17	475.50	188 x 228 x 18	392.40
9 x 26 x 12	31.50	22.5 x 43.5 x 16.5	68.40	52 x 61 x 25	57.90	203 x 247.5 x 16	409.80
9 x 41 x 11.5	51.00	23 x 94 x 14	168.90	52 x 75 x 12	79.50	205 x 254 x 28	800.40
10 x 32.2 x 14	46.50	24.5 x 48 x 11	51.30	53 x 76 x 12	80.10	254 x 304 x 20	755.70
10 x 40.2 x 20	74.40	25 x 50 x 10	51.30	54 x 75 x 11	75.30	255 x 300 x 20	615.60
12 x 51 x 20	100.20	25 x 65 x 18	113.10	58 x 61 x 25	44.40	275 x 364 x 30	1,785.00
12 x 64 x 16	111.90	25 x 127 x 20	398.70	59 x 80 x 11	77.10	290 x 360.5 x 30	1,515.00
12 x 68 x 17	136.20	25.4 x 38.1 x 7.93	31.80	60 x 127 x 12.7	229.20	300 x 350 x 20	830.70
12 x 165 x 20	564.30	25.4 x 45 x 16	54.00	60.3 x 139.1 x 15.87	326.10	300 x 360 x 30	1,362.30
12.7 x 22.22 x 12.7	29.10	25.5 x 35.2 x 8	30.60	80 x 100 x 12	95.40	350 x 460 x 25	2,418.30
13.5 x 49.1 x 18	82.50	28 x 60 x 8	55.50	85 x 110 x 16	140.10	453 x 503 x 24	1,536.90
14 x 26 x 5.5	27.60	28.37 x 46.5 x 16	53.70	95 x 146 x 25	396.30		

Note : Prices for NBR polymer.

Gurudev Says :

Formality improves communication; cordiality improves communion – oneness.

Sri Sri Ravishankar

TDUO H SEAL / PISTON SEAL ASSEMBLY



MATERIAL : NITRILE RUBBER 72 SHORE A MILD STEEL BODY

OPERATING LIMITS :

WORKING PRESSURE: ≤ 1.2Mpa (12 bar)

TEMPERATURE: -20 °C TO +100 °C

MEDIUM : COMPRESSED AIR

LINEAR VELOCITY : ≤ 1m/s

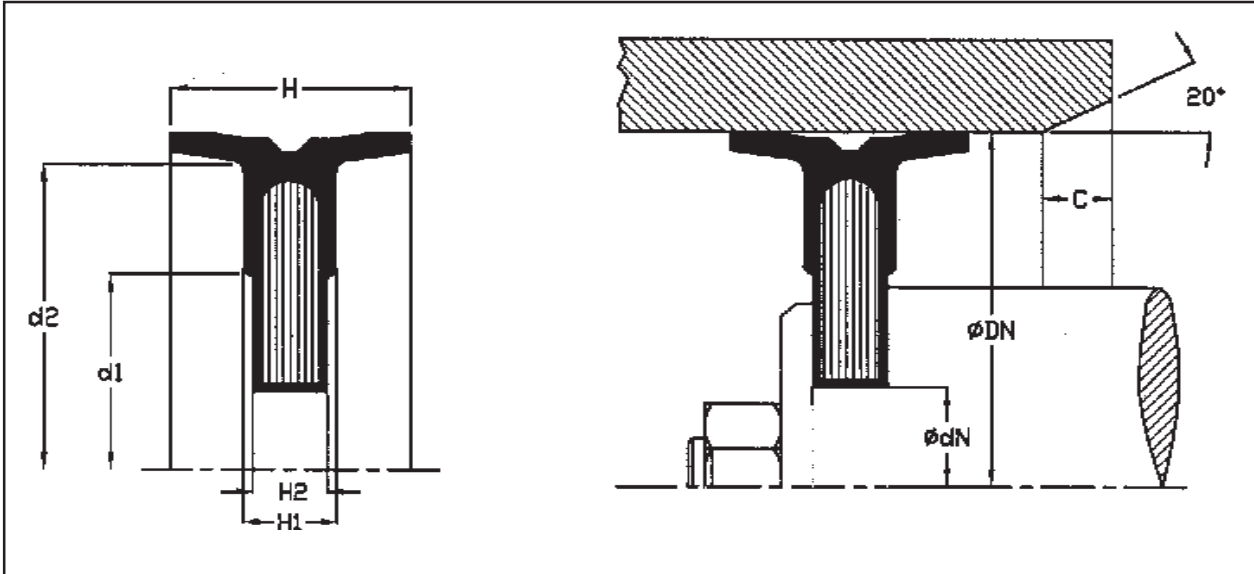

SIZES IN MM

I.D. x O.D. x Th.	TYPE OF POLYMER	PRICE PER NO.	I.D. x O.D. x Th.	TYPE OF POLYMER	PRICE PER NO.	I.D. x O.D. x Th.	TYPE OF POLYMER	PRICE PER NO.
8 x 24 x 12	NBR	105.00	8 x 50 x 20	NBR	225.00	16 x 100 x 25	NBR	900.00
8 x 25 x 12	NBR	105.00	10 x 50 x 18	NBR	225.00	16.2 x 63 x 21.5	NBR	300.00
8 x 24 / 25.4 x 12.5	NBR	105.00	10 x 50 x 25	NBR	225.00	18 x 100 x 25	NBR	900.00
DIA 32 (P)	NBR	177.00	DIA50 (P)	NBR	300.00	20 x 100 x 27.5	NBR	900.00
10 x 32.6 x 18	NBR	141.00	10 x 55 x 20	NBR	270.00	20 x 120 x 40	NBR	1650.00
12 x 35 x 26	NBR	177.00	10 x 55 x 25	NBR	270.00	20 x 122 x 40	NBR	1752.00
10 x 40 x 18	NBR	165.00	10 x 55.5 x 14	NBR	270.00	20 x 150 x 40	NBR	2565.00
10 x 40 x 24	NBR	180.00	10 x 57 x 14	NBR	270.00	25 x 130 x 45	NBR	1860.00
10 x 45 x 25	NBR	210.00	12 x 75 x 30	NBR	495.00	27 x 160 x 32	NBR	2910.00
10 x 45 x 65	NBR	522.00	14 x 63 x 32	NBR	330.00	32 x 203.5 x 38	NBR	4500.00

Note : Piston Seal assembly moulded with metal to rubber.

**PTFE Back-up Rings/
Machined Components**



Back-up rings are used to prevent seal extrusion under high pressure. Available in solid or spiral types.



These seals are ideal for low friction applications and are widely used in hydraulic and pneumatic systems.

Gurudev Says :

Faith is realizing that you always get what you need. Faith is giving the Divine a chance to act.

Sri Sri Ravishankar